



**Welcome  
to your  
launchpad.**





## NEW TRADITIONS

Tradition grounds us. That others have been here before allows us to find our footing and stand tall. And for those of us not willing to simply hold fast, we use its firm foundation to push off on our own journey. In the heart of the liveliest village on the plain, òLiv Auburn embraces tradition and inspires you to make new ones all your own. It gracefully blends the warmth and charm of familiarity with the excitement and charge of modern coolness. So you can share in all the customs and comfort of home, while you boldly step into what's next.







# Amenities

## ROOFTOP POOL DECK:

- Rooftop Sundeck with Pool and Built-in Seating
- Outdoor Lounge with Built-in Seating, BBQ Area and Fire Pits

## HEALTH + WELLNESS

- Fitness Center with State-of-the-Art Equipment
- Yoga Room
- Spa with Sauna & Steam Room
- Dog Run

## WORK + STUDY

- Clubroom with TVs, Lounge Space with Coffee Bar
- Executive Business Area with Macs, PCs & Printers
- Outdoor Private Study Terrace

## TECHNOLOGY + SECURITY

- Controlled Access and Key FOB System Throughout
- Assigned Parking Available in Access Controlled Garage
- Free, Secured, Indoor Bike Storage
- Free High Speed Wi-Fi Throughout the Building

Amenities and features subject to change without notice.





# Features

## SHARED SPACES

- Fully Furnished with Modern, Custom-Designed Furniture
- Custom Roller Shades in Living Room
- Full-Size Washer and Dryer in Each Apartment
- 55" Smart TV in Each Living Room
- Wood-Style Flooring
- Insulated Interior Walls
- USB Ports in Kitchen & Bedrooms
- Large Openable Windows with Energy Efficient Low-E Double Pane Glass\*
- Private Terrace\*

## KITCHEN

- Premium Stainless Steel Range, Oven, Microwave, Dishwasher and Refrigerator
- Quartz Countertops
- Designer Cabinetry & Architectural Track Lighting in Kitchen

## BEDROOM

- Walk-In Closets with Built-In Closet Organizers\*
- Blackout Shades\*
- Modern Ceiling Fan with Light
- Independently Keyed Bedrooms with Solid Wood Doors

## BATHROOM

- Bluetooth Showerhead Speaker
- Walk-in Showers with Glass Enclosure
- High-End Plumbing Fixtures
- Designer Custom Cabinetry

Amenities and features subject to change without notice.

\*In select units.



VIP Unit



VIP Unit



# Elevate your space by upgrading your lifestyle with **ōLiv+**

## VIP UNIT

- Located on the Top Floor
- Smart Home Technology Including
  - Smart Thermostat
  - Amazon Echo Show
  - Smart Lighting
- In-Unit Sound System
- Upgraded 65" Smart TV\*
- Upgraded Memory Foam Mattress
- Custom Backsplash in Kitchen
- Upgrade Cabinet and Countertops
- Wood Paneled Ceiling & Custom Wood Headboards
- Upgraded Unit Size and Design
- Upgraded Furniture Package with Added Nightstand
- Upgraded Lighting Throughout
- Light Dimmers in Bedrooms and Living Room
- Upgraded Refrigerator with Water and Ice Dispenser
- Upgraded Tile Flooring and Wall in Bathrooms
- Additional Shelving and Vanity Organizer in Bathrooms
- Upgraded Closet Organization

## MANSION UNIT

- Private, Outdoor Terrace with Furniture
- Private Hot Tub on Terrace
- Smart Home Technology Including
  - Smart Thermostat
  - Amazon Echo Show
  - Smart Lighting
- In-Unit Sound System
- Upgraded 60-65" Smart TV\*
- Upgraded Memory Foam Mattress
- Custom Quartz Backsplash in Kitchen
- Upgrade Cabinet and Countertops
- Wood Paneled Ceiling & Custom Wood Headboards
- Upgraded Unit Size and Design
- Upgraded Furniture Package with Added Nightstand
- Upgraded Lighting Throughout
- Light Dimmers in Bedrooms and Living Room
- Upgraded Refrigerator with Water and Ice Dispenser
- Upgraded Tile Flooring and Wall in Bathrooms
- Additional Shelving and Vanity Organizer in Bathrooms
- Upgraded Closet Organization

Amenities and features subject to change without notice.

\*In select units.

# Take your pick.

From stylish studios to VIP suites, we've got a layout for every lifestyle.

## Studio

### STUDIO

Choose from: Murphy or Studio

SQFT Range: 330 - 549

**Upgrade to a VIP unit**

## 2 BR

### TWO BEDROOMS

Choose from: One or Two Bathrooms

SQFT Range: 793 - 1,029

**Upgrade to a VIP unit**

## 3 BR

### THREE BEDROOMS

Choose from: Three or three and half Bathrooms

SQFT Range: 975 - 1,178

**Upgrade to a VIP unit**

## 4 BR

### FOUR BEDROOMS

Choose from: Two, Three or Four Bathrooms

SQFT Range: 1,017-1,527

**Upgrade to a VIP unit**

## 5 BR

### FIVE BEDROOMS

Choose from: Three, Four or Five Bathrooms

SQFT Range: 1,335-1,402

**Upgrade to a VIP unit**

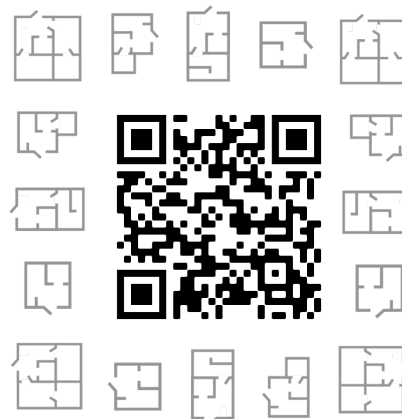

## Find your space.

Scan to browse **34** unique floor plans.

For details on additional fees, parking rates and other details, please see the website.

Please note floorplans may differ in range, square footage, and price.





# oLiv Lifestyle

## LIFESTYLE FEATURES:

- Serving Auburn University
- Located on the Corner Cox and Genelda
- Convenient Access to Shopping, Restaurants, Nightlife, and Greek Life
- On-site, Professional Management and Maintenance
- Double Occupancy\*
- Roommate Matching Available\*
- Individual Leases
- FREE Internet with building wide WIFI and high-speed

\*In select units.

## MODERN COMMUNITY

oLiv is designed to build community and connections. We put you right in the center of it all, so you can explore everything the city has to offer. At oLiv, you'll build the relationships and connections that help you live your best and pursue what matters most.





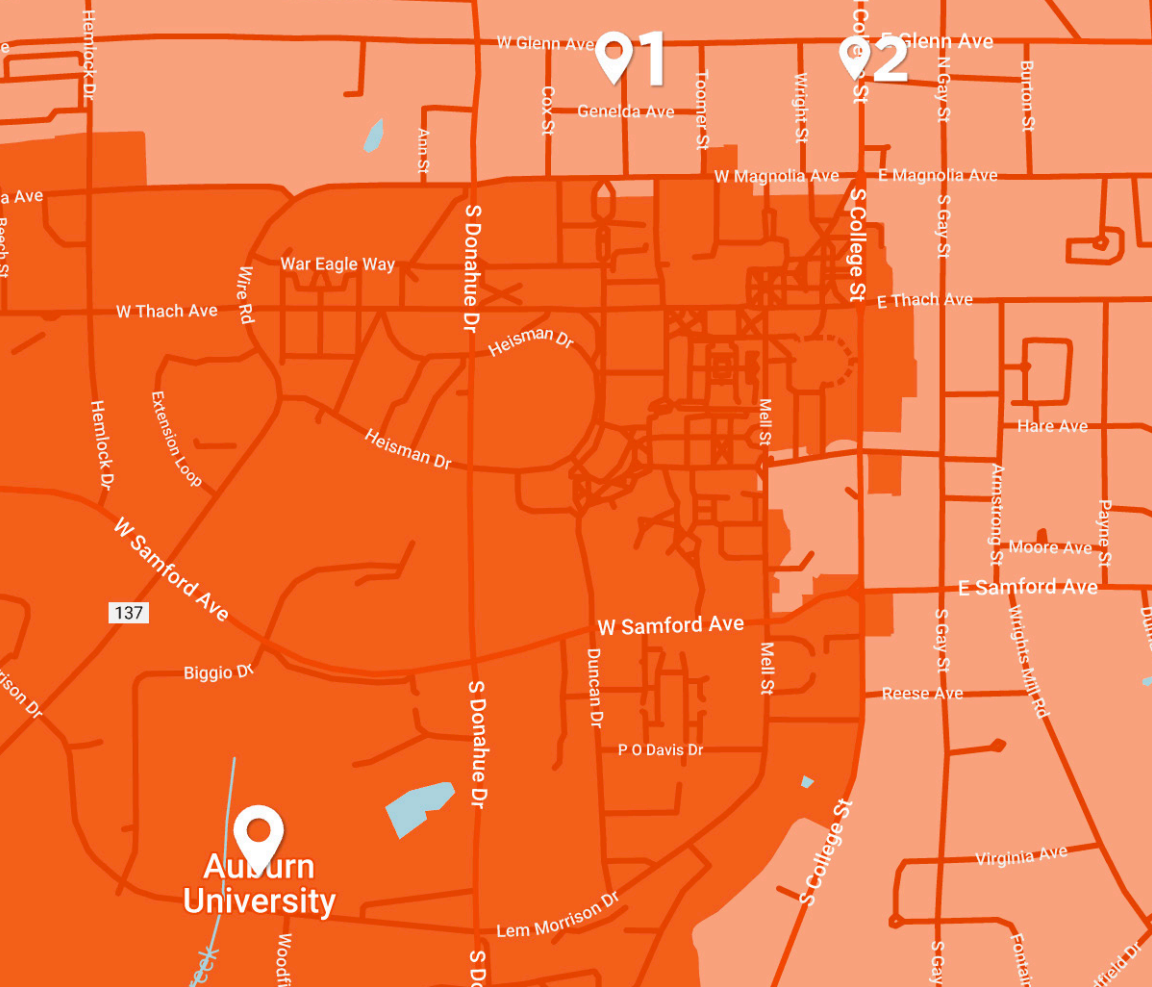

# Let's chat.



**1. Property Address:**  
336 Genelda Ave., Auburn AL 36830

**2. Leasing Address:**  
152 N College St, Auburn, AL 36830  
Mon-Fri 10-7, Sat 10-5 and Sun 1-5

Lease@OlivAuburn.com  
334-246-0075

@OlivAuburn

**olivauburn.com**